

Mont Terri Rock Laboratory

The Mont Terri Rock Laboratory (FMT) is located near St-Ursanne in Canton Jura at a depth of around 300 metres below the surface in the vicinity of the security gallery of the Mont Terri motorway tunnel. Numerous international organisations are involved in a wide range of experiments in the **Opalinus Clay**; these are carried out in niches and tunnels covering a total length of around 600 metres. The Swiss Federal Office of Topography (swisstopo) in Bern manages the project and Nagra is one of the project partners.

Instructions for visitors

- Guided tours of the FMT take place year-round. The laboratory is partly closed to visitors in July and August. Details can be found on the Mont Terri homepage www.mont-terri.ch "Visits".
- Visits can be arranged **in advance (with date and time)** through **Nagra** (056 437 11 11) or **through another Swiss partner: ENSI or swisstopo**.
- Groups are welcome from Monday to Saturday. Tours can be held in the morning or afternoon upon request.
- **Recommended group sizes are between 10 and 42 people**. Smaller groups may be able to join other tours and larger groups may have to be divided up.
- **Travel** to the FMT should be organised individually by visitors via train, bus or car. The meeting-point is usually Mont Terri visitors' centre near the railway station (Gare CFF) in 2882 St-Ursanne. Please consult the location plan on the reverse side.
- The **tour programme** lasts around 2½ hours: a 45-minute introduction and discussion and a tour of the exhibition in the visitors' centre and around 1:45 hours for the guided tour in the tunnels (including transfer by minibus to the laboratory facilities).
- The temperature in the tunnels is around **13°C year-round**. Warm clothing and suitable footwear (rubber soles) are advisable. Increased dust and noise are to be expected during construction periods. Helmets will be distributed by laboratory employees before the tour and these must be worn at all times in the tunnel.
- Tours of the FMT are free.

How to reach us / location plan

By bus / car

- From Delémont (Canton Jura), take the A16 motorway in the direction of Porrentruy and, immediately after the Mont Russelin tunnel, take the St-Ursanne exit. Then follow the main road, bearing left in the direction of St Ursanne. After 200 m, turn right towards St-Ursanne railway station.

Meeting-point

- The visitors' centre is 200 m to the east of the SBB/CFF railway station

Location plan: Visitor Center Mont Terri

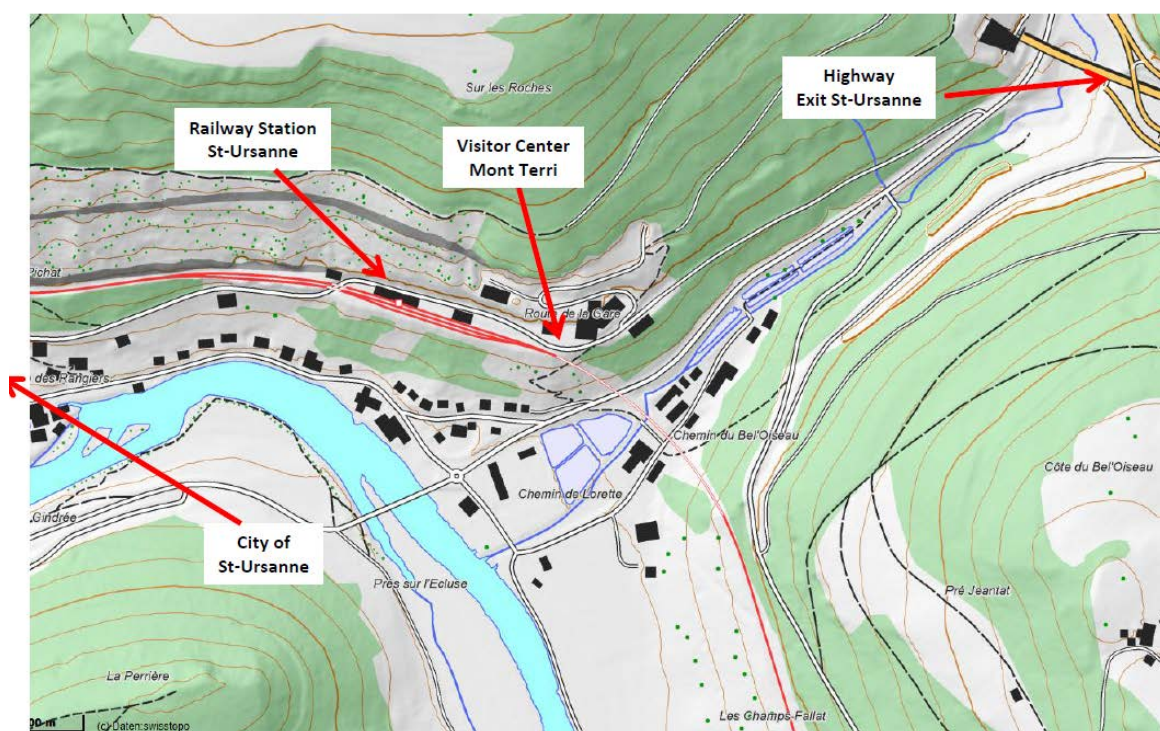

By train (examples, no guarantee on correctness, please check www.sbb.ch)

Visitors travelling by train: leave the train at St-Ursanne station. Check the SBB timetable [here](#)

Morning:

08:37 from Basel	>	09:37 in St-Ursanne (always xx:07 and xx:37)
08:12 from Bern	>	09:37 in St-Ursanne (ditto)
07:34 from Zürich	>	09:37 in St-Ursanne (ditto)

Afternoon:

13:03 from Basel	>	14:07 in St-Ursanne (ditto)
12:42 from Bern	>	14:07 in St-Ursanne (ditto)
12:03 from Zürich	>	14:07 in St-Ursanne (ditto)

From St-Ursanne to Delémont:

xx:09 und xx:39